

LEVITAZ Boards Manual



Levitaz®

Manual for Levitaz Board

GDM001707-ENG-C

Table of Contents

1	INTRODUCTION	2
2	SAFETY INSTRUCTIONS.....	3
3	APPLICATION OF THE PRODUCT AND TECHNICAL DATA.....	4
3.1	Connection to the kitefoil.....	4
4	BOARD INSTALLATION INSTRUCTIONS.....	5
4.1	Footstraps installation for all Levitaz boards	5
4.2	Pad installation to Transformer board	6
4.3	Fin installation to Transformer board	7
4.4	Kitefoil installation to Transformer board	7
4.5	Kitefoil installation to Exo, Match and Raze board	8
5	PACKAGING AND STORAGE	9
6	MAINTENANCE AND REPAIR INFORMATION.....	10
6.1	Maintenance	10
6.2	Repair information.....	10
7	DISPOSING OF USED PARTS.....	10
8	ORDERING REPLACEMENT PARTS.....	11
	CONTACT INFORMATION	12

1 INTRODUCTION

General information

The Levitaz boards are for kiting on water only.

This manual contains important information about the proper use of the product and its safety. Follow these instructions carefully and precisely. This helps to reduce the risk of damage to the product or personal injury.

- This manual is part of the product.
- Keep this manual in a safe place for the entire life of the product.
- If the product is transferred to a new owner, this manual and all associated documents must be passed on to the new owner.

The meaning and appearance of safety symbols used in this manual are as follows:

 WARNING!	The text after the signal word “WARNING!” contains important information, which must be followed to avoid serious personal injury or death.
--	--

NOTICE!	The text after the signal word “NOTICE!” contains information, which must be followed to avoid damage to the product.
----------------	--

Because there are inherent risks of injury in the use of this product and kite boarding in general, even following all of the next instructions will not eliminate the risk of injury to you or others. Levitaz a brand of Geislinger GmbH is not responsible for injuries or damage to the product due to misuse or any use not consistent with the “Safety instructions”.

2 SAFETY INSTRUCTIONS



WARNING!

Kite boarding is an inherently dangerous activity that can result in serious injury or death to the user or people in proximity to the user, with or without a Levitaz product. These risks include drowning or being hit by the product if the user loses control of it. The product may increase the risk of some injuries to users or bystanders by adding additional structure to the board that may strike users or bystanders; by increasing the speed at which the kite board can be operated, or by changing the manner in which an out-of-control kite board reacts as it contacts water or ground during an out-of-control situation. The use of this product and participation in the sport involves inherent risk of injury or death. To reduce the risks:

- Read the manual for important information about the installation, care and maintenance of the board before use.
- Always wear an approved life and protection vest.
- Always wear a suitable helmet.
- For use by trained (iko-level 4: advanced) personnel only.
- This product is designed for use on water only.
- Surf under control and do not use at speeds that exceed the skills of the rider.
- Do not use in shallow water or near the shore, docks, pylons, swimmers or other activities.
- The users are responsible for their safety and the safety of those around them.
- Components in this product are subject to the random forces of natural elements and are subject to irregular wear.
- Use only original Levitaz replacement parts.
- It is the user's responsibility to inspect equipment for wear before every use.
- It is the user's responsibility to repair and maintain this product.
- The use of damaged products is not allowed.
- Before riding ensure that the screws are tightened with the tightening torque that is described in this manual.
- Geislinger GmbH is not responsible for injuries or damage to the product due to misuse or any use not consistent with these instructions.
- Do not use this product under the influence of alcohol or drugs.
- Minimum age of rider: 18 years

Failure to follow these instructions may increase the risk of serious personal injury or death, damage to the product or both.

3 APPLICATION OF THE PRODUCT AND TECHNICAL DATA

The product will only function properly if it has been mounted according to the instructions contained in this manual. Carefully follow these instructions.



WARNING!

This product is designed for use on water and by trained personnel (over 18 years) only.

Failure to do so may cause serious personal injury or death, damage to the product or both.

If the connection bolts between the kitefoil and the board are not delivered by Levitaz, please make sure to use stainless bolts provided with a minimum strength class 70.

3.1 Connection to the kitefoil

The distance between bolts onto the mounting surface for the mast is 90 mm wide (and 165 mm long).

- The bolt contact surface (between bolt and mast) must be at least 20 mm in diameter. Levitaz recommends using washers to prevent wear. See figure 3.1.

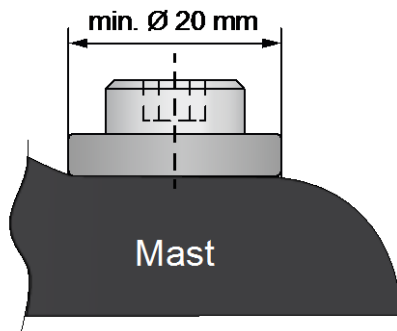

Figure 3.1: Washer



WARNING!

The user is responsible for compatibility with the kitefoil. Do not exceed the maximum permissible unevenness of 1mm between the kitefoil and the board.

Failure to do so may result in the product not operating properly, can reduce its service life, and possibly result in injury to the user or others.

4 BOARD INSTALLATION INSTRUCTIONS

4.1 Footstraps installation for all Levitaz boards

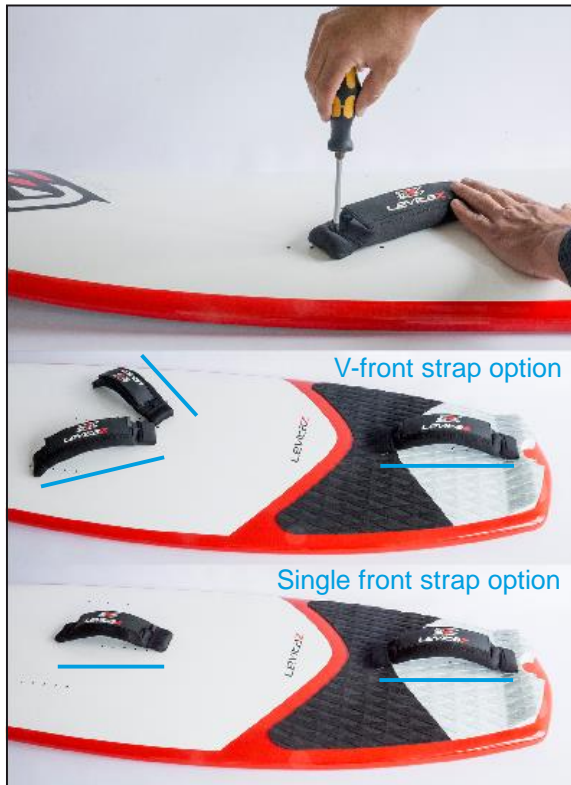

- Mount footstraps with a cross tip screw driver. Use two of the included M5 screws with washers (between screw and footstrap) for one footstrap. There are two options (see figure 4.1) possible.

NOTE: Special thread inserts for Levitaz Transformer.

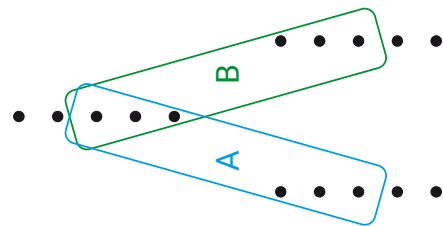

You can choose which rear footstrap setup you prefer (variant A or B).

Single front strap option:

Not available for Levitaz Raze board.

Figure 4.1: Symbol photo: Straps installation for possible front strap options

NOTICE!

Do not use an electric screwdriver, a hammer or any sharp objects for the assembly or disassembly process.

This may cause serious damage to the product.

4.2 Pad installation to Transformer board



Figure 4.2: Symbol photo: Pad installation

- Make sure that the pad holes are congruent to the board threaded inserts. See figure 4.2.
- Loosen the adhesive film.
- Stick pad onto the board.
- Press it down.

4.3 Fin installation to Transformer board



How to install a FCS II fin in your Transformer board:

- Insert the front of the fin into the plug (see figure 4.3).
- Use downward pressure to lock the fin in place.
- When you hear the click, it's secured.

To release, grab a towel and protect your hand before doing the following (see figure 4.3):

- Hold the surfboard firmly.
- Lift up at the back of the fin.

Learn more under:

www.surffcs.com/fin-systems/fcs-ii

Figure 4.3: Symbol photo: Fin installation to Transformer board

4.4 Kitefoil installation to Transformer board



Figure 4.4: Symbol photo: Kitefoil installation to board

- Mount kitefoil with a hexagon socket bolt (two positions are possible – The further front the foil is mounted the more pressure you will have at your front foot). Use the four M8 bolts with washers (between bolt and kitefoil, see figure 3.1) for mounting the kitefoil to the board. Tighten all four M8 bolts to 9 ± 1 Nm tightening torque.

Only for hybrid mast: Use the plastic washers added under the metal washers (mast > plastic washer > metal washer > bolt).

Note: For kite foiling Levitaz recommends foiling without fins.

4.5 Kitefoil installation to Exo, Match and Raze board



- Mount kitefoil with a hexagon socket bolt. Use the four M8 bolts with washers (between bolt and kitefoil, see figure 3.1) and threaded inserts for mounting.

Only for hybrid mast: Use the plastic washers added under the metal washers (mast > plastic washer > metal washer > bolt).

1. Insert two threaded insert and M8 bolts into each track.
2. Dismount the bolts. Only the four threaded inserts are in the tracks.
3. Position the foil plate over the threaded inserts in the track until you can insert the bolts with washers into the threaded inserts in each track.
4. Before tightening the bolts, place the mast on your desired position. See Figure 4.6.
5. Tighten all four M8 bolts to 9 ± 1 Nm tightening torque.

Figure 4.5: Symbol photo: Kitefoil installation to boards with sliding track system



Figure 4.6: Mast position possibilities for front foot pressure

The further front the foil is mounted the more pressure you will have at your front foot. For initial installation we recommend to mount the foil in a middle position.

5 PACKAGING AND STORAGE

All parts are packed in a cardboard box and PE film.

- Take the product parts out of the box.
- Remove the packing film from the product parts. Check the product parts for possible damage that may have occurred during transportation.

DISPOSAL OF STANDARD PACKAGING

The cardboard box and PE film can be recycled.

STORAGE INSTRUCTIONS

The following instructions must be observed to prevent the product from being damaged during storage:

NOTICE!	<p>Only store the product clean and dry in disassembled condition, in its covers and in a suitable bag for optimal protection.</p> <p>Failure to do so can reduce the service life of the product.</p>
----------------	--

- Do not place heavy parts on top of the product.
- Do not leave or store the product in cars.
- Protect the product from direct sunlight or heat.

Storage temperatures:

NOT PERMITTED	OPTIMAL	PERMITTED UP TO	NOT PERMITTED
< -30°C (-22 F)	-10°C - +25°C (+14 F - +77 F)	+80°C (+176 F)	> +80°C (+176 F)

6 MAINTENANCE AND REPAIR INFORMATION

6.1 Maintenance

Clean all board parts with fresh water after every use, disassemble the foil and dry the parts. Don't put any sand into the threads before assembling. Always store the product disassembled in a suitable bag for optimal protection.

NOTICE!	Failure to do so may cause serious damage to the product and void the warranty.
----------------	---

6.2 Repair information

INSPECTED CONDITION	CORRECTIVE MEASURE
It is not clear if the damage is critical or not.	Take a photo, document the extent of the damage and contact Levitaz for advice.

If damage or wear to the product is identified contact Levitaz to identify the appropriate corrective measure. See www.levitaz.com

Dispose of worn parts as instructed in the chapter "Disposing of used parts".

7 DISPOSING OF USED PARTS

After replacing individual components:

- All metal parts can be recycled (scrap metal).
- The board must be disposed of as residual waste.

Federal, state and local regulations must always be observed when disposing of the product or parts thereof.

8 ORDERING REPLACEMENT PARTS

NOTICE!	<p>Use only original Levitaz replacement parts.</p> <p>Failure to do so may cause serious damage to the product and void the warranty.</p>
----------------	--

CONTACT INFORMATION

LEVITAZ

a brand of Geislinger GmbH
Hallwanger Landesstr. 3
5300 Hallwang/Salzburg
AUSTRIA

T: +43 662 66 999-0
F: +43 662 66 999-40
E: office@levitaz.com
levitaz.com



FLY OVER WATER



Levita**Z**.com

LEVITAZ

a brand of Geislinger GmbH
Hallwanger Landesstr. 3
5300 Hallwang/Salzburg
AUSTRIA

T: +43 662 66 999-0

F: +43 662 66 999-40

E: office@levitaz.com



*Levita**Z***[®]